

## Liquid Fuel Hot Air Apparatus

It is ideal for heating places of large volume such as poultry houses, greenhouses, factories, mosques, meeting rooms, sport facilities and restaurants.

Thanks to the 3 pass system, chimney gas temperature decreases since the smoke path is extended, providing fuel savings.

It produces the hot/dry air required for drying processes in sectors such as leather, dye, textile, grape drying and food.

It only works with liquid fuel (Fuel-Oil, Natural Gas, Diesel) and has easy and fast installation by its power connection.

The Economy and digital thermostat controlled burner ensures safety together with its safety thermostat with low investment and operation costs.

The mono-block body is isolated with fiberglass and external protection is provided by plates dyed using electrostatic powder dye.

The air supplied out to the medium is regulated by radial fans. Silent Operation.

Burner is not included in the price.

### Technical Features

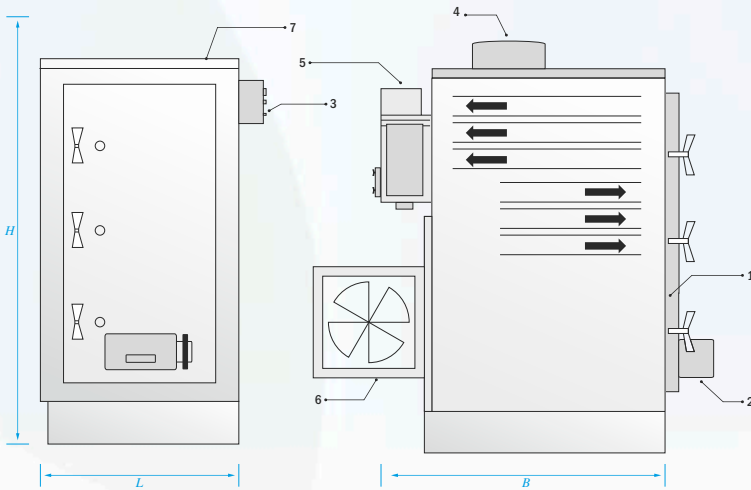

### Part Descriptions

- |                      |                      |             |
|----------------------|----------------------|-------------|
| 1) Cover             | 4) Sıcak Hava Çıkışı | 6) Arka Fan |
| 2) Brülör            | 5) Chimney           | 7) Boiler   |
| 3) Electricity Board |                      |             |



Model		YTMH 150	YTMH 200	YTMH 250	YTMH 300	YTMH 350	YTMH 400	YTMH 500	YTMH 600
Heating Capacity	Kcal/h	150.000	200.000	250.000	300.000	350.000	400.000	500.000	600.000
Chimney (Duman)	Ø	50							
Chimney (Clean Air - Isrtma)	cm	30 x 25						30 x 30	
Fan Flux	m³	12.000	14.000	16.000	18.000	m³' e göre debi seçimi			
H (Height)	mm	150				170			
B (width)	mm	130				150		180	
L (Boiler Length)	mm	77				87		97	
B1 Back Fan Width	mm	120			150			170	
B2 Boiler Width	mm	50							
L1Control Panel Width	mm	20							